

altaeuro

better modern cabinetry

by

U.S.

CABINET
DEPOT



HIGH PERFORMANCE FRAMELESS CABINETRY

TORINO

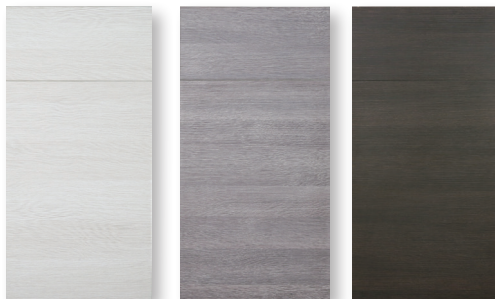

WHITE PINE

GREY WOOD

DARK WOOD

TORINO STYLE FEATURES HORIZONTAL WOOD GRAIN
DEEP TEXTURED MELAMINE

PALERMO



GLOSS WHITE

PALERMO STYLE FEATURES HIGH GLOSS PET
LAMINATE WITH SEAMLESS EDGE

RIVIERA



OYSTER SHELL

CONCH SHELL

RIVIERA STYLE FEATURES VERTICAL WEATHERED
WOOD GRAIN TEXTURED MELAMINE



PRODUCT DETAILS

- 18MM (3/4") PLYWOOD COMPOSITE CONSTRUCTION WITH THERMOFUSED MELAMINE SURFACE IN & OUT
- UNIVERSAL CABINET BOX WITH GREY LINEN FINISH
- ALL EDGES ARE EDGE BANDED WITH 1MM MATCHING PVC EDGE BANDING WITH RADIUS EDGES
- WOOD DOWEL AND EUROPEAN STYLE SCREW ASSEMBLY
- depthplus 13-1/2" DEEP WALL

architecturalgrade ENGINEERING & CONSTRUCTION

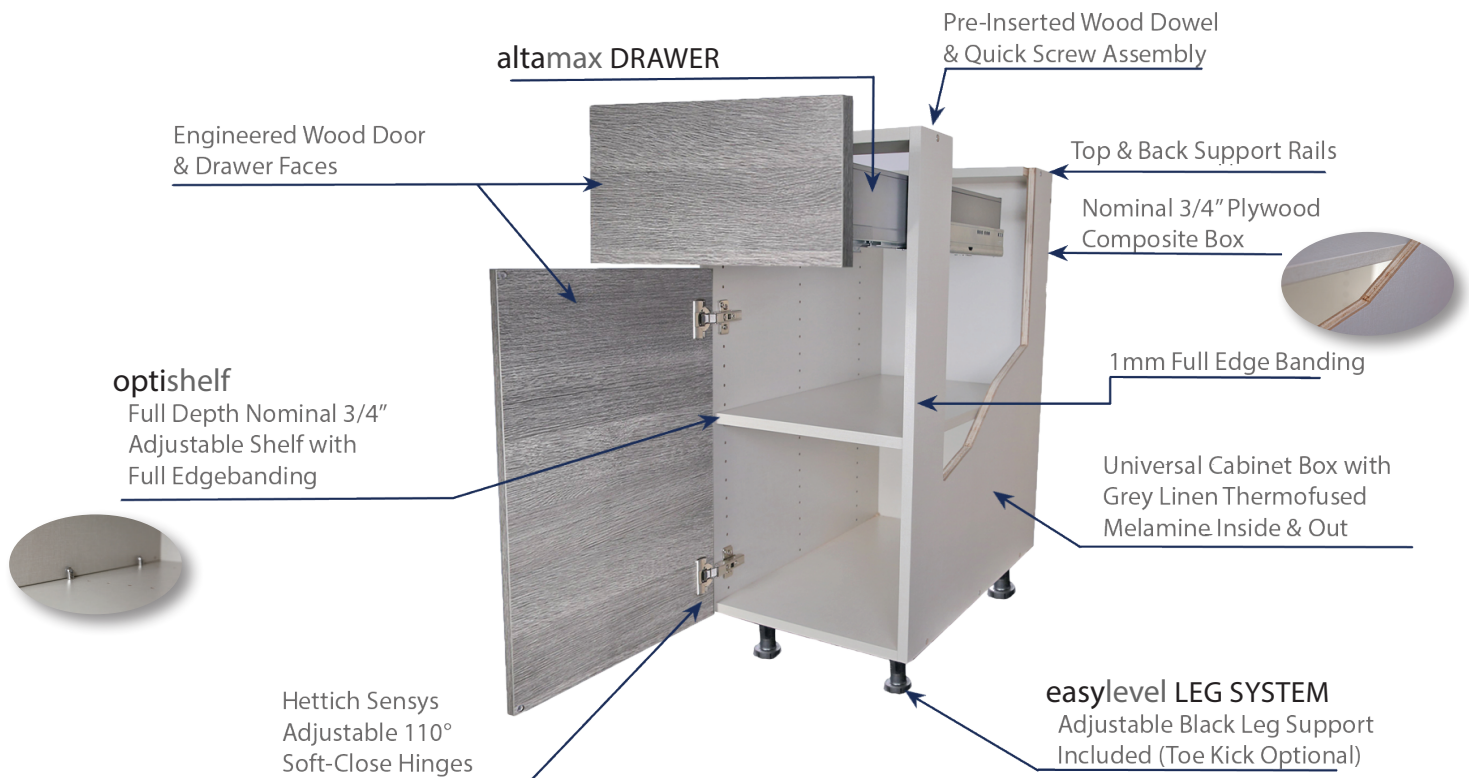

altaeuro
better modern cabinetry
by **U.S. CABINET DEPOT**

CASSELBERRY

Traditional mitered door frames, beveled raised center panels, and hand glazed details



ANTIQUE WHITE



SADDLE

TORRANCE

Transitional mortise and tenon door frames with beveled raised center panels



WHITE



DOVE

YORK

Transitional mitered door with a recessed center panel framed by simple beveling



ANTIQUE WHITE



SHAKER

Modern Mortise and Tenon Door with a Framed Flat Recessed Panel



WHITE



ANTIQUE WHITE



DOVE



GREY

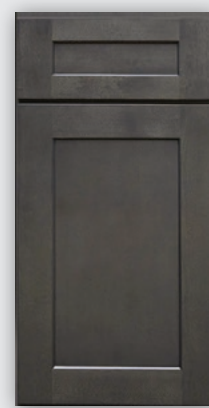

CINDER

HIGHLAND SERIES

BOX CONSTRUCTION

- 1/2" Plywood Box Construction w/ Matching Exterior
- UV Coated Natural Interior
- 1/2" Plywood Full Height Back Panel
- 3/4" Hardwood Face Frame
- Full Extension Soft-Close Drawer Glides
- 5/8" Dovetail Drawer Box

OTHER FEATURES

- Traditional to Contemporary Door Styles Available
- Expansive Cabinet & Accessory SKU Availability
- Glue & Staple or Metal Bracket Assembly
- Available RTA or fully Assembled
- CARB2 Compliant & KCMA Certified

U.S.

CABINET
DEPOT

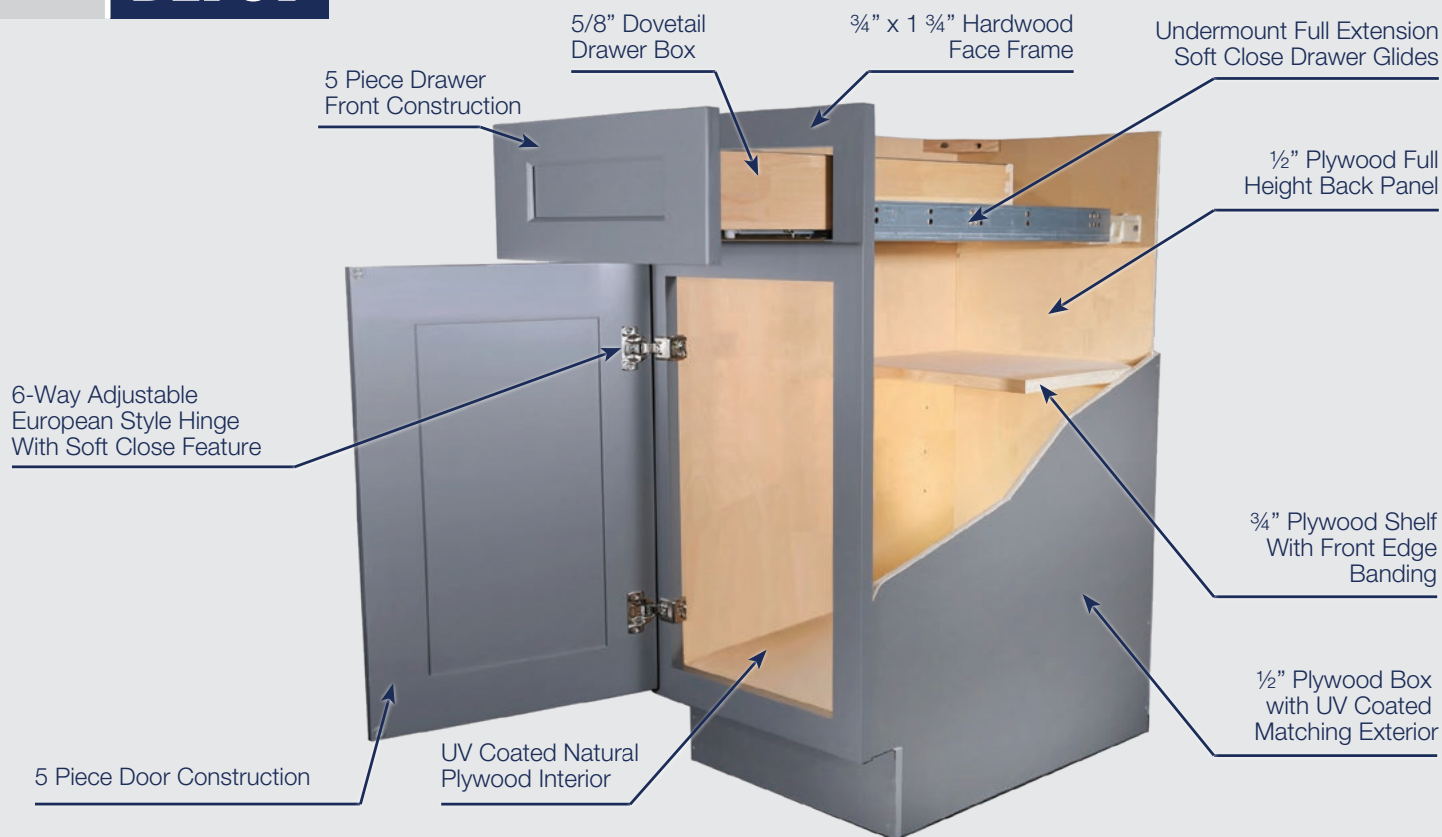



Wilmington

ANGLED



CLASSIC MOULDING SMOOTH
V1



STRAP MOULDING
V2



SOLID WOOD BAND
V3

HIGHLAND COLLECTION

FEATURES

- Angled Chimney (Trimmable by 6")
- Moulding on Base (Varies by Style)
- Plywood/Maple Construction
- Available unfinished (raw) or finished in any one of the Highland Series' paints/stains.
- Two-Piece construction for easy mounting & access to fan and ducting.

AVAILABLE SIZES

30" WIDE

30"W X 36"H
30"W X 48"H

36" WIDE

36"W X 36"H
36"W X 48"H

42" WIDE

42"W X 36"H
42"W X 48"H

48" WIDE

48"W X 36"H
48"W X 48"H

Range hood styles with straps have a varying number of straps dependent on hood width.

- 30" - One Strap
- 36" - Two Straps
- 42" - Two Straps
- 48" - Three Straps

